

# MH Mega Bore 3-Jaw High-Speed Open Center Chuck



## Application / Benefits

For work requiring a large through-hole

## Technical features

Wedge hook style chuck with high gripping force

## ACTUAL GRIPPING FORCE DIAGRAM

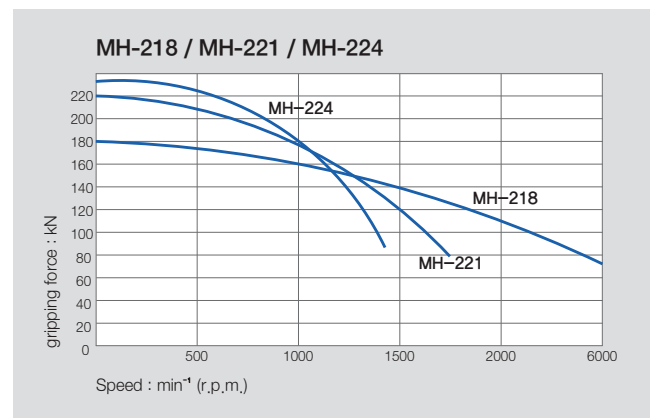
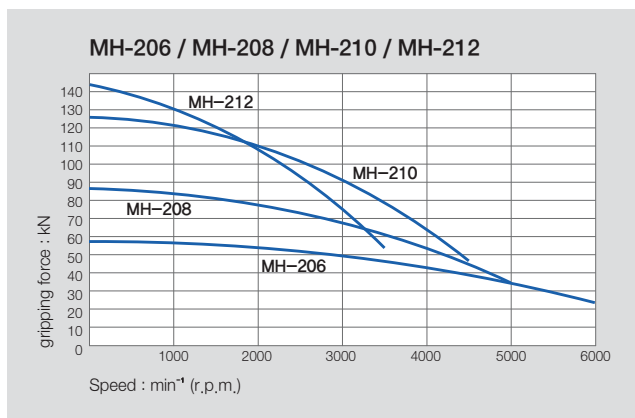

## SPECIFICATIONS

	MH-206	MH-208	MH-210	MH-212	MH-218	MH-221	MH-224
Thru Hole Dia. [mm]	52	66	82	103	166.5	166.5	190
Grip Dia. Max [mm]	175	210	254	315	457	530	610
Grip Dia. Min. [mm]	16.5	23	30	54	73	105	120
Jaw Stroke Dia. [mm]	6.4	7.4	8.8	10.6	11.5	10.6	10.6
Plunger Stroke [mm]	15	17.5	19	23	25	23	23
Max. Permissible Input Force [kN(kgf)]	24.7(2551)	36.4(3596)	49(4976)	55(5608)	71(7240)	90(9177)	90(9177)
Max. Static Gripping Force [kN(kgf)]	57.3(5847)	87(8872)	126.6(12848)	144(14686)	180(18355)	220(22460)	234(23861)
Max. r.p.m. [min <sup>-1</sup> ]	6000	5000	4500	3000	2000	1700	1400
Weight [kg]	11.9	23	32	55.3	170	228	293
Moment of inertia [N · m <sup>2</sup> (kg · m <sup>2</sup> )]	2.26(0.23)	5.6(0.57)	12.37(1.26)	28.93(2.95)	174.6(17.8)	342.1(34.7)	651(66.4)
Operating Cylinder	SH-15052 (SYH-1552)	SH-17068 (SYH-1768)	SH-19082	SH-21010	SYHL-2816	SYHL-2816	SHL-39024
Max. Hydraulic Pressure [MPa(kgf/cm <sup>2</sup> )]	1.78(18.1)	2.34(23.9)	2.74(28)	2.65(27.2)	3.07(32)	2.86(29.1)	1.57(16.1)
Operating Hard Jaw	HB06A1	HB08A1	HB10A1	HB12N1	HB15A1	HB18B2	HB18B2

※ Specifications are subject to change without notice.

※ Samchully Machinery Co., Ltd. is no longer an OEM manufacturer for Kitagawa® Iron Works Co., Ltd.

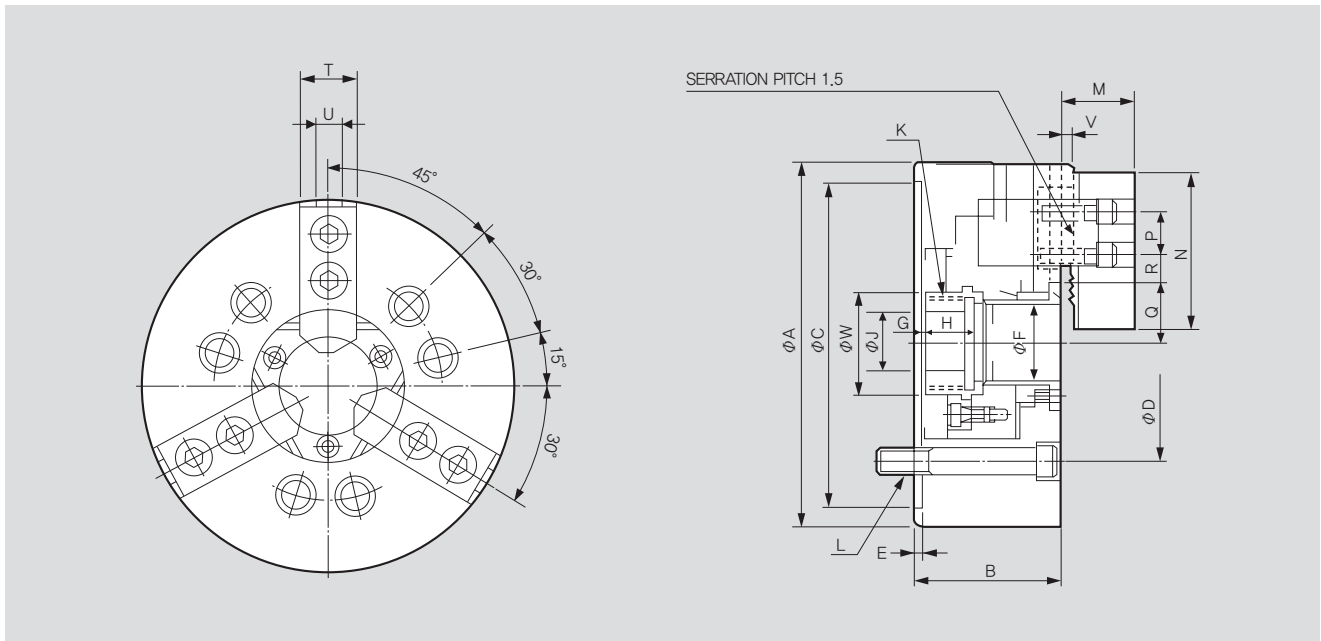

※ It is recommended to grease chucks at least twice a day in order to maximize longevity.

## DIMENSIONS

	MH-206	MH-208	MH-210	MH-212	MH-218	MH-221	MH-224
$\Phi A$	175	210	254	315	457	530	610
B	81	91	100	110	135	140	149
$\Phi C(H6)$	140	170	220	300	380	380	380
$\Phi D$	104.8	133.4	171.4	235	300.2	330.2	330.2
E	5	5	5	6	6	6	6
$\Phi F$	52	66	82	103	166.5	166.5	190
G max.	14	7.5	8.5	8	8	11	20
G min.	-1	-10	-10.5	-15	-23	-12	-3
H	17.5	27	25	28	50	39	40.5
$\Phi J$	20	30	52	82.5	107	80	80
K max.	M60x2.0	M75x2.0	M90x2.0	M116x2.0	M175x3.0	M180x3.0	M200x3.0
L	3-M10x95	6-M12x115	6-M16x120	6-M20x130	6-M20x130	6-M22x140	6-M22x150
M	33	39	43	51	69	73	73
N	72	95	110	111	165	180	180
P	20	25	30	30	50	60	60
Q max.	38	45.7	54.5	67.3	102	111.75	119.5
Q min.	34.8	42	50.1	62	96.25	106.5	114.2
R max.	21.75	23.75	32.25	45.75	58.25	72.5	105.5
R min.	10.25	11.75	14.25	15.75	20.25	21.5	21.5
T	31	35	40	49	69	65	65
U	12	14	16	21	22	25	25
V	2	2	2	2	5	5	5
$\Phi W$	65	80	101	124	186	197	210

※ Blank and machined draw-nuts are available.

### RELATED PRODUCT

